

M/V BLUE VEGA

MULTIPURPOSE OFFSHORE SUPPORT VESSEL

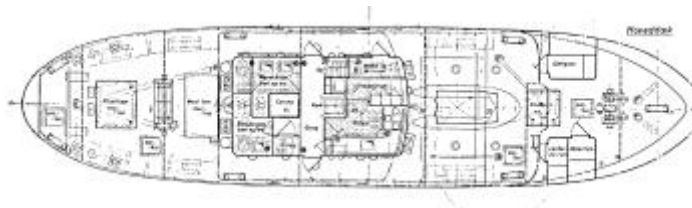
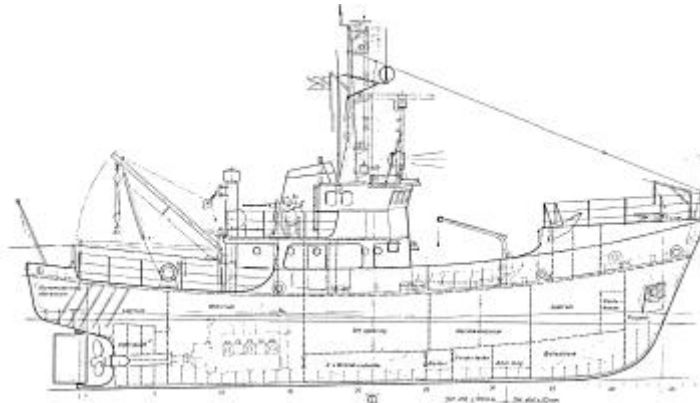

BLUE STAR LINE Ltd.

Kanalvej 17, DK 5600 Faaborg
Tel. +45 63 60 00 52 - 24 hrs.Duty phone +45 22 16 06 02 – Fax +45 63 60 01 09
www.bluestarline.com post@bluestarline.com

M/V BLUE VEGA

MULTIPURPOSE OFFSHORE SUPPORT VESSEL

REGISTRATION

Name	M/V Blue Vega
Owner	Blue Star Line Ltd.
Year built/rebuilt	1969
Year converted	2008
Flag	Panama
Classification	IBS Unrestricted navigation
IMO No.	9547491
Call Sign	HP5182
Home Port	Panama

MAIN CHARACTERISTICS

Length overall	25,64 m
Breadth moulded	6,00 m
Depth moulded	3,20 m
Draft max.	2,70 m
Gross tonnage	104,5 t
Net tonnage	83,6 t

PROPULSION

Main Engine	B&W Alpha 405-26 VO 500 HP
Propel	B&W Alpha Pitch propeller
Gear	B&W Alpha
Aux. Engines	2 x MWM Type 229-4
Generators	2 x Stamford 40 kva

BUNKERS

Fuel	12,2 cbm
Lube	0,4 cbm
Freshwater	5,8 cbm

PERFORMANCE

Maximum Speed	11 knots
Service Speed	9,5 knots
Consumption a day : Steaming app	1,2 cbm
Working offshore app	0,7 cbm

CREW

Master	1
Chief mate	1
Chief engineer	1
Total	3

ACCOMODATION

Cabins	4x1 pax
	1x6 pax
Toilets	2
Showers	2
Messroom	1
Galley	1

DECK EQUIPMENT

Anchor winch	
Foredeck:	1 x Deck crane HMF 1,25 ts at 6 m
Aftdeck:	
Towing winch	
Towing hook with safety release	

HOLD CAPACITY

32 cbm
Hatch 2x2 mtr.

NAVIGATION/COMM. EQUIPMENT

1 x Simrad AP 45 autopilot
1 x Simrad RGC 50 gyro
1 x Furuno FR 2110 arpa radar
2 x Furuno GP 32 GPS
1 x Furuno FA 50 AIS transponder
1 x Kelvin Hughes echo sounder
1 x Furuno Max Sea plotter
1 x Koden KS-538 direction finder
1 x JRC NCR 300 navtex
1 x Ben Galatee Log
1 x JRC Fleet 33 satellite email and phone
1 x Sailor GMDSS MF/HF radiostation A1. A2
1 x Sailor C401 VHF
1 x Sailor RM2042 VHF DSC
1 x Sailor RT2048 VHF
2 x Sailor SP3520 GMDSS VHF portable
1 x Sailor Sart
1 x Sailor SE406 Epirb
1 x Sailor Epirb floatfree

LIFE SAVING EQUIPMENT

2 Viking life rafts for each 10 persons
3 Viking survival suits
11 Mermaid life jackets
Firefighting equipment according to regulations